

TOWN HWY. No.	LENGTH IN MILES		
	CLASS 3	CLASS 4	
9	0.27		SCHOOL ST
25	0.10		ENGLISH CEMETERY RD
27	0.31		GILMAN ST
28	0.11		FOLSOM HILL RD
69	0.08		CHURCH ST
70	0.06		GRIST MILL PL
TOTAL	0.93	0.00	

MILEAGE SUMMARY			
CLASS 2			
TH-1	0.280		
TH-2	0.300		
	TOTAL CLASS 2		0.580
CLASS 3			
	TOTAL CLASS 3		0.93
	TOTAL TOWN		1.510
US HIGHWAY			
US-2	0.824		
	TOTAL US HIGHWAY		0.824
	TOTAL STATE		0.824
TOTAL, TRAVELED HIGHWAYS, FEB. 10, 2018:			2.334
<small>(Excludes Class 4 and Legal Trail Mileage)</small>			

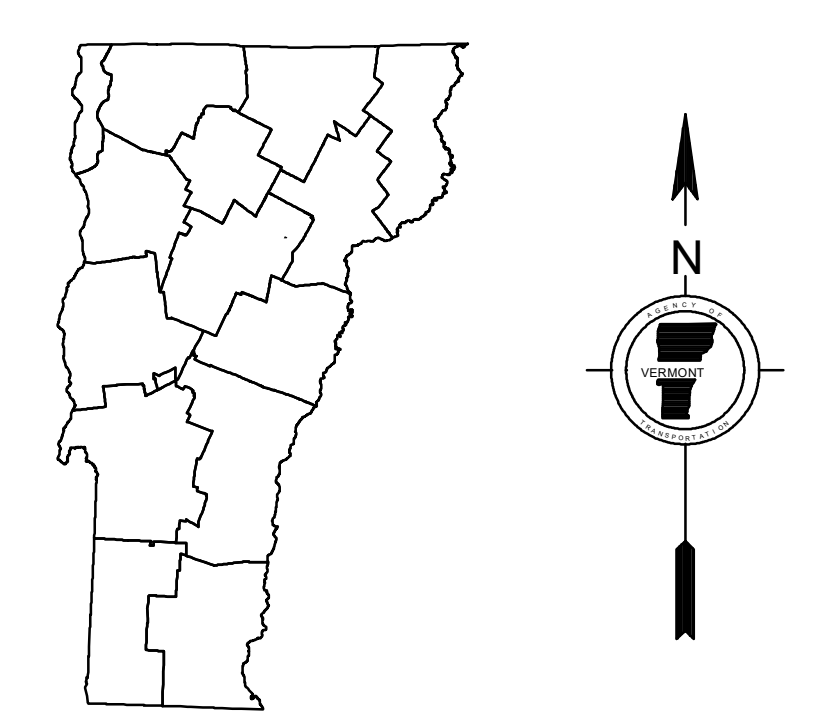
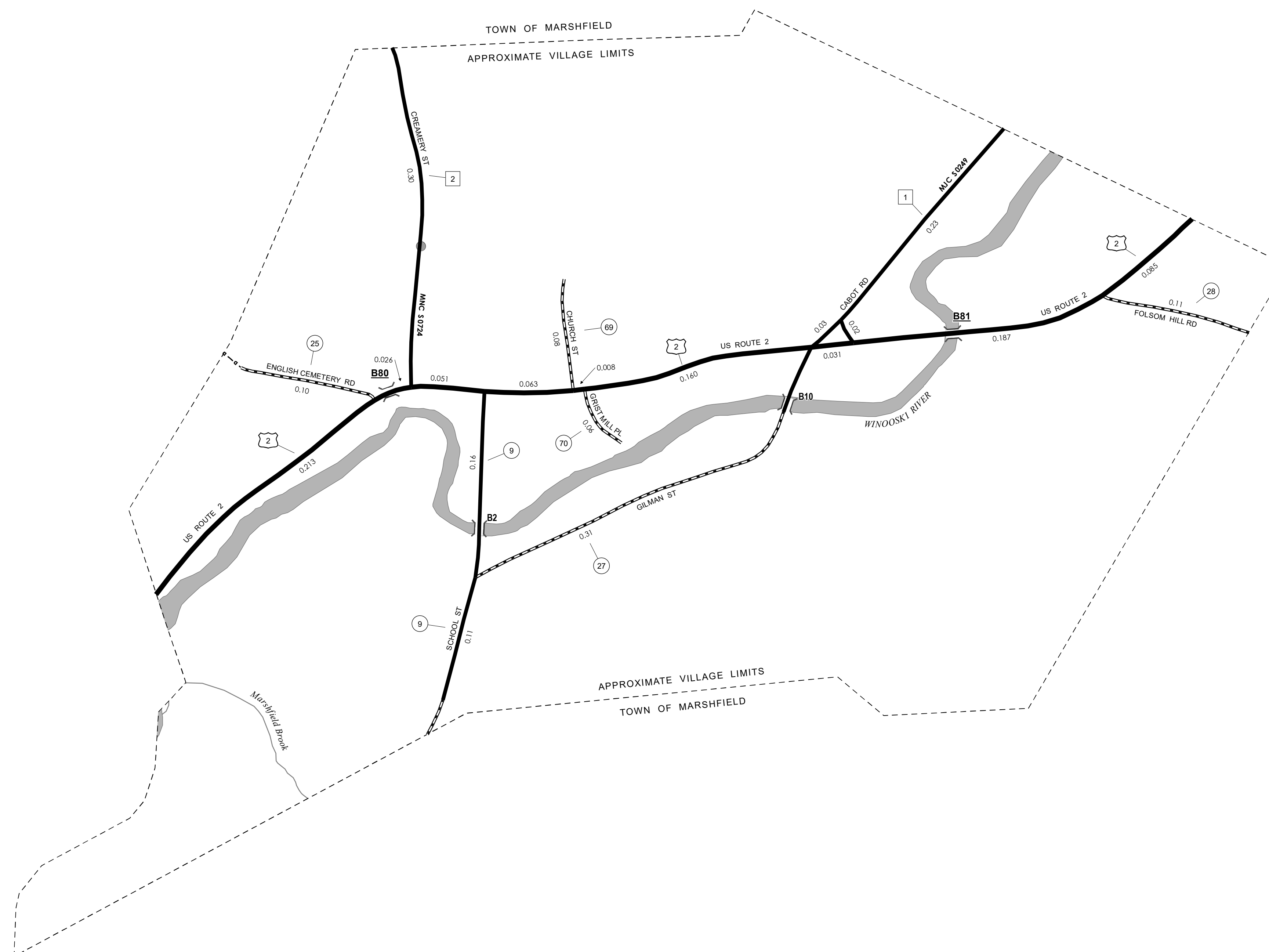

VERMONT GENERAL HIGHWAY MAP Village of Marshfield

WASHINGTON COUNTY
Transportation District #7

Prepared by the
Vermont Agency of Transportation
Division of Policy, Planning and Intermodal Development
in cooperation with
U.S. Department of Transportation
Federal Highway Administration

Mileage as of February 10, 2018
Map prepared June 28, 2018

SCALE 1:3,168

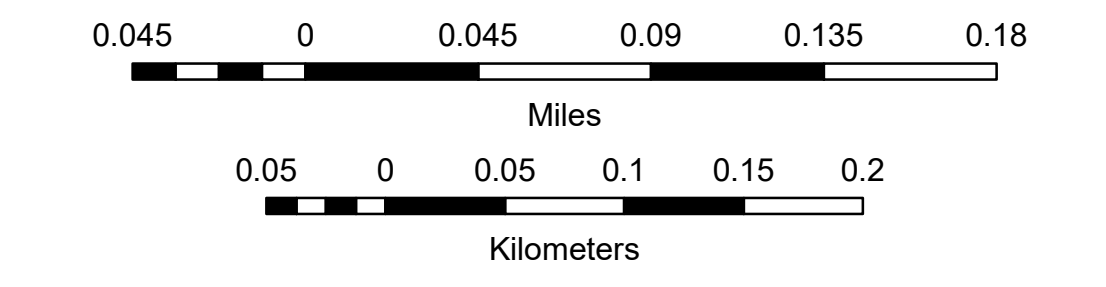

<p>HIGHWAYS</p> <ul style="list-style-type: none"> INTERSTATE U.S. ROUTE STATE ROUTE CLASS 1 CLASS 2 CLASS 3 CLASS 4 LEGAL TRAIL PARK AND RIDE 	<ul style="list-style-type: none"> INTERSTATE OR DIVIDED HIGHWAY STATE - HARD SURFACE OR PAVED TOWN - HARD SURFACE OR PAVED GRAVEL SOIL OR GRADED AND DRAINED EARTH UNIMPROVED OR PRIMITIVE IMPASSABLE OR UNTRAVELED LEGAL TRAIL DISCONTINUED HIGHWAY CLASS CHANGE RAILROAD INACTIVE RAILROAD PUBLIC LAND - NATIONAL FOREST PUBLIC LAND - STATE/MUNICIPAL NFR NATIONAL FOREST ROAD SFH STATE FOREST HIGHWAY 	<p>POLITICAL SUBDIVISIONS</p> <ul style="list-style-type: none"> STATE BOUNDARY COUNTY BOUNDARY TOWN BOUNDARY VILLAGE BOUNDARY URBAN COMPACT BOUNDARY WATER BODY STREAM OR BROOK <p>BRIDGE OR CULVERT</p> <ul style="list-style-type: none"> BRIDGE OR CULVERT > 20' BRIDGE OR CULVERT 6' - 20' BIKE PATH STRUCTURE VT CULVERTS BRIDGE VT CULVERTS CULVERT > 6' B34 / C34 STATE BRIDGE OR CULVERT IDENTIFIER B34 / C34 TOWN BRIDGE OR CULVERT IDENTIFIER 	<p>FEDERAL CLASSIFICATION IDENTIFIER</p> <ul style="list-style-type: none"> MA MINOR ARTERIAL MJC MAJOR COLLECTOR MNC MINOR COLLECTOR PA PRINCIPAL ARTERIAL
--	---	--	--

DISCLAIMER:
The untraveled highways (laid-out town highways), discontinued highways, and legal trails herein are those of which the Agency of Transportation has record; others may exist.

Highway and bridge data by the Agency of Transportation. Town short structures drawn from the VTCULVERTS (formerly VOBCIT) online database. All other data from the Vermont Center for Geographic Information. Only named streams shown.

Vermont State Plane Coordinate System
North American Datum of 1983
SPCS_Zone_Identifier: 4400
Geodetic Reference System 80
2,000-meter grid, Easting - Northing